

**BOUNDARY TREATMENTS**

Existing Closed Boarded Timber Fence with Concrete Posts

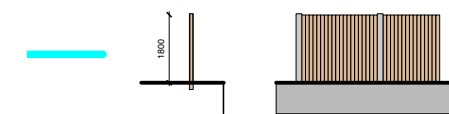

Closed boarded 2400mm timber fence with matching gate (stained to match cladding)

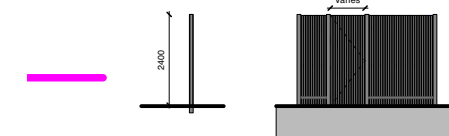

Closed boarded 1800mm timber fence with matching gate (stained to match cladding)



1800mm hedge with 1500mm powder coated black flat bar steel railing.

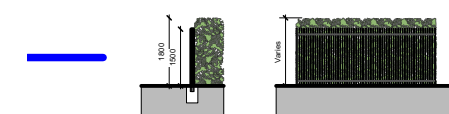

Low hedge (height varies)



Low height protective railing (1200mm)

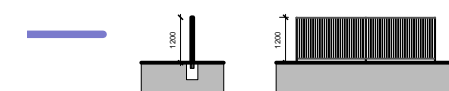

Existing stone wall (height varies)

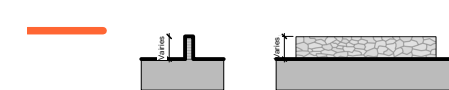

**Note:**

Drawing for planning purposes only.

For landscaping treatments see  
1321-108-Proposed Indicative Landscape Plan

**DK-Architects**

26 Old Haymarket  
Liverpool  
L1 6ER  
0151 231 1209 T  
mail@dk-architects.com E  
www.dk-architects.com W

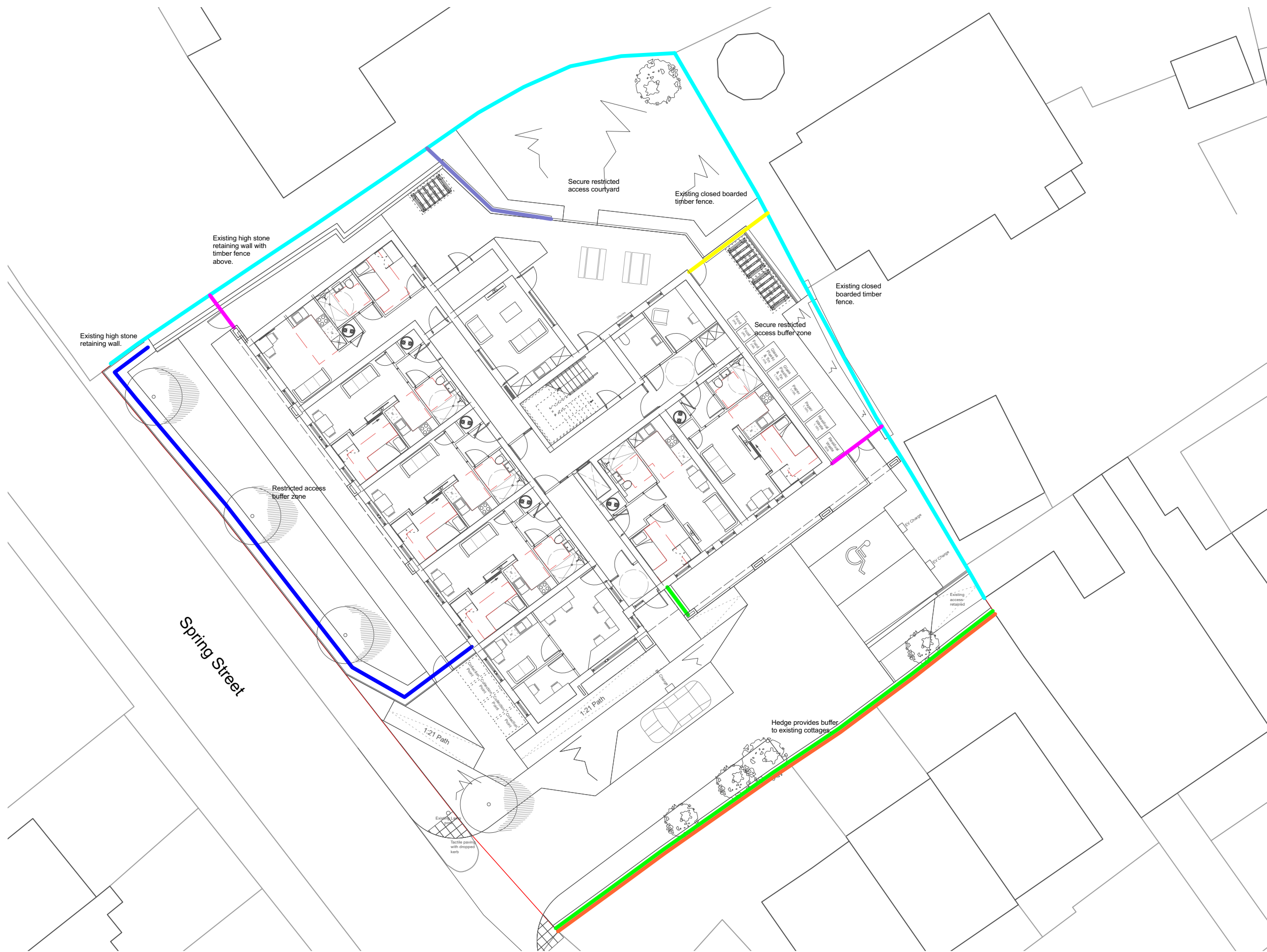

Drawing Title: Proposed Boundary Treatment Plan revision: F  
Date: 01/09/2023  
Drawing no: 1321-105  
Scale: 1:200 @ A3  
Drawn: EC

